

# LACAVA

## AQUAGRANDE

AQG-W-17

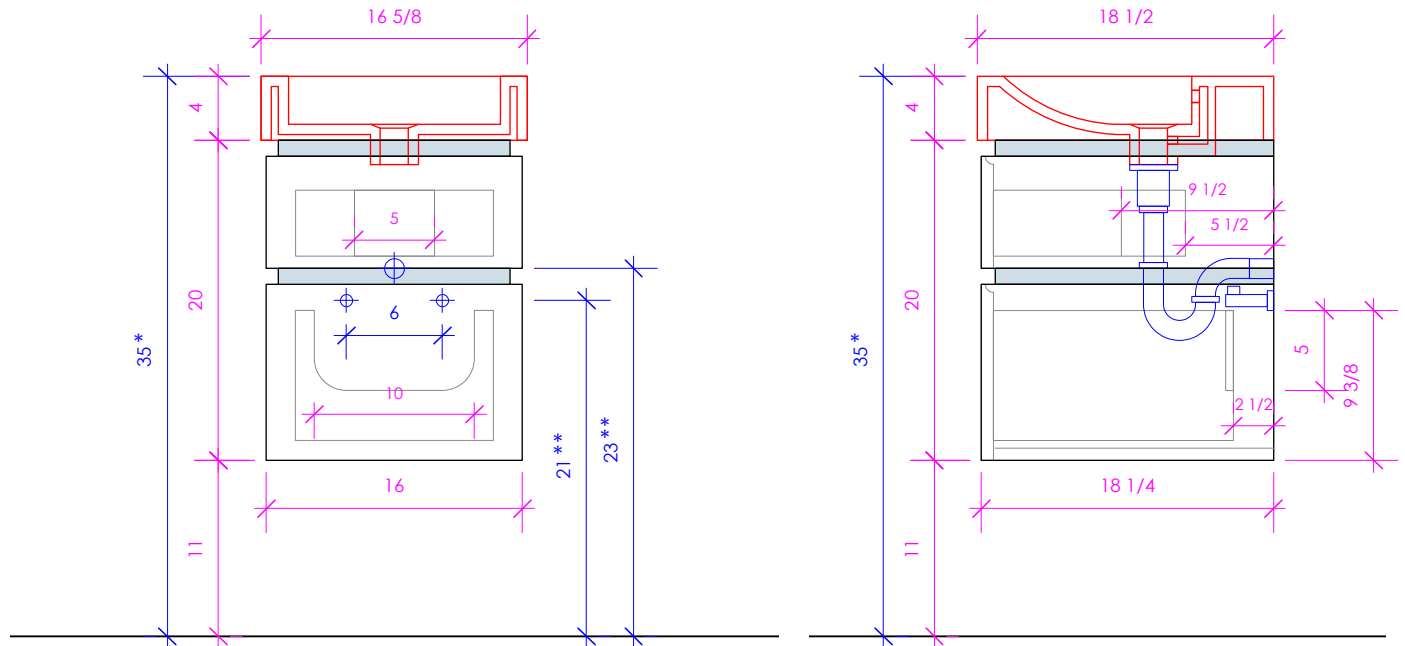

\* Recommended installation height  
 \*\* Recommended plumbing location

### FEATURES:

- WALL MOUNT VANITY
- TWO DRAWERS WITH SELF-CLOSE GLIDES
- DRAWER BOXES STAINED TO REFLECT EXTERIOR FINISH
- DECORATIVE POLISHED TRIM OPTIONAL
- ROUTED FINGERPULLS
- USED WITH 5066A SINK (SOLD SEPARATELY)
- MOUNTING: FRENCH CLEAT (INCLUDED)  
(SEE FURNITURE MANUAL)
- PROUDLY HANDMADE IN THE USA
- MANUFACTURED WITH LOW VOC FINISHES AND WOOD FROM RENEWABLE FORESTS

### FINISHES:

#### WOOD:

##### STANDARD:

02 - NATURAL CHERRY  
 07 - NATURAL WALNUT  
 24 - CLASSIC WALNUT  
 20 - ASH GRAY  
 06 - WENGE  
 33 - AFRICAN MAHOGANY

##### PREMIUM:

22 - GRAY ZEBRA  
 31 - WHITE OAK  
 27 - RUSTIC  
 47 - SMOKY WALNUT

##### LUXURY:

37 - WEATHERED OAK  
 52 - SILVER OAK  
 50 - HORIZON BLUE

46 - DRIFTWOOD  
 \*NEWTERRA ONLY\*

08 - MATTE WHITE  
 35 - MATTE ARDESIA  
 54 - MATTE TAUPE  
 16 - MATTE BLACK  
 42 - MATTE OLIVE GREEN  
 39 - MATTE SAGE  
 28 - MATTE AZURE  
 29 - MATTE CLOUD  
 40 - MATTE ZEST

85 - GLOSS WHITE  
 88 - GLOSS ARDESIA  
 84 - GLOSS TAUPE  
 86 - GLOSS BLACK  
 42 - GLOSS OLIVE GREEN  
 08T1 - WHITE W/ TEXTURE  
 35T1 - ARDESIA W/ TEXTURE  
 54T1 - TAUPE W/ TEXTURE  
 16T1 - BLACK W/ TEXTURE  
 82T1 - OLIVE GREEN W/ TEXTURE

#### COUNTERTOP:

##### STONE:

WH - BIANCO  
 LN - LINAC  
 SL - ATHENS

##### QUARTZ:

FR - FURIO  
 AH - ASH

##### SOLID SURFACE:

M - SATIN WHITE  
 G - POLISHED WHITE  
 R - MARMO  
 V - LAVA  
 D - OBSIDIAN

##### CONCRETE:

SND - SAND  
 SLT - SLATE  
 TER - TERRACOTTA  
 CHL - CHARCOAL

#### METALS:

##### METAL:

21 - BRUSHED STAINLESS STEEL  
 10 - POLISHED STAINLESS STEEL  
 44 - MATTE BLACK  
 MW - MATTE WHITE  
 BPW - BRASS POWDER COAT

LACAVA reserves the right to revise any dimension or information on this sheet without notice. Dimensions are nominal and may vary within an industry accepted tolerance of 1/4". Cabinets with 'vanity top' sinks are made to the matching sink and dimensions may vary. LACAVA is not responsible for any cutouts, countertops, or furniture made without the actual product or template. Differences in color, grain, appearance, and texture are inherent in all natural woodwork and should be expected. Variances in these qualities are not deemed manufacturing defects and will not be accepted as valid reasons for return or exchanges. Plumbing specifications are only a guideline and may need alteration based on application.

6630 WEST WRIGHTWOOD  
 CHICAGO, IL 60707

PH: 773-637-9600  
 FAX: 773-637-9601

LACAVA.COM  
 INFO@LACAVA.COM