

## Specifications:

<b>Installation:</b>	deck mount 3-hole, two levers
<b>Exterior Dimensions:</b>	H: 5 1/4" SPOUT: 6 3/4"
<b>Material:</b>	solid brass construction
<b>Water use:</b>	1.2 GPM
<b>Pop-up:</b>	no
<b>Finishes:</b>	CR - polished chrome PN - polished nickel NI - brushed nickel BG - brushed gold 44 - matte black
<b>Cutout Size:</b>	Ø 1 3/8"
<b>Accessories included:</b>	24" flexible hot/cold water supply lines and #7100-16OF European click-clack drain

## Features:

- Deck-mount three hole faucet with two lever handles
- Brass construction with hot and cold ceramic cartridge
- Complements the Cigno Collection

## Codes + Standards:

- Meets and exceeds applicable national codes and standards
  - ASME A112.18.1/CSA B125.1
  - NSF/ANSI/CAN61
  - NSF/ANSI/CAN372
  - CalGreen/CEC
- Compliant with California AB-100



compliant when installed to specific requirements of this regulation



## Recommended Items:

- Replacement parts:
  - R027-28 - Replacement ceramic disc cartridge pair
  - 1582-AERATOR - Replacement aerator cartridge
- European drain with overflow
  - 7100-16OF Click-clack drain
  - 7100-13OF stationary drain

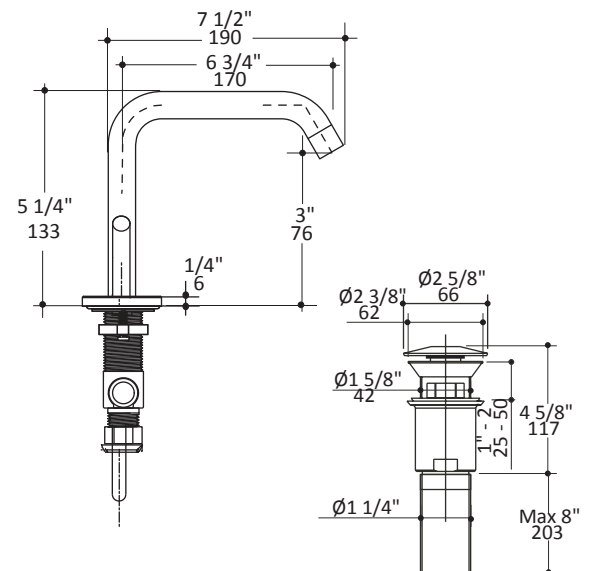
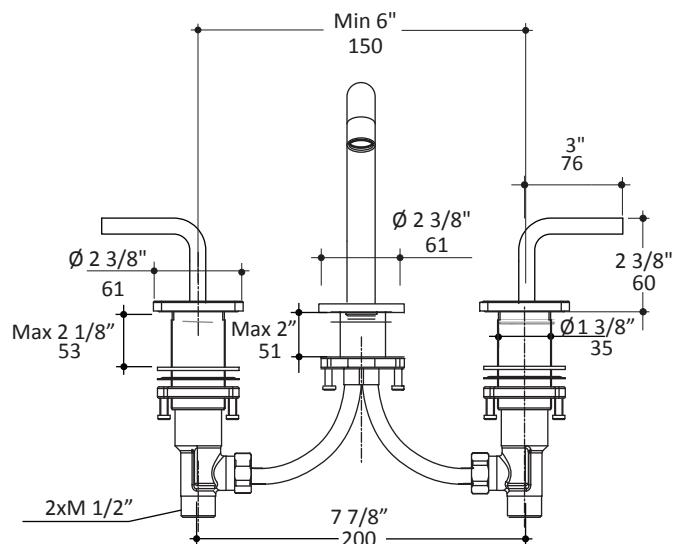

LACAVA reserves the right to revise any dimension or information on this sheet without notice. Dimensions are nominal and may vary within an industry accepted tolerance of 1/4". Drawings provided herein are meant to give the user an idea of the product and are not made to scale. Location of plumbing is meant for reference, your specific application may vary.

Revised: 01/26/2024